

# ARMSTRONG ACRES

BEING THE  
E<sup>1</sup>/<sub>2</sub> SE<sup>1</sup>/<sub>4</sub> SEC. 6, T. 12N-R. 3W. I.M.

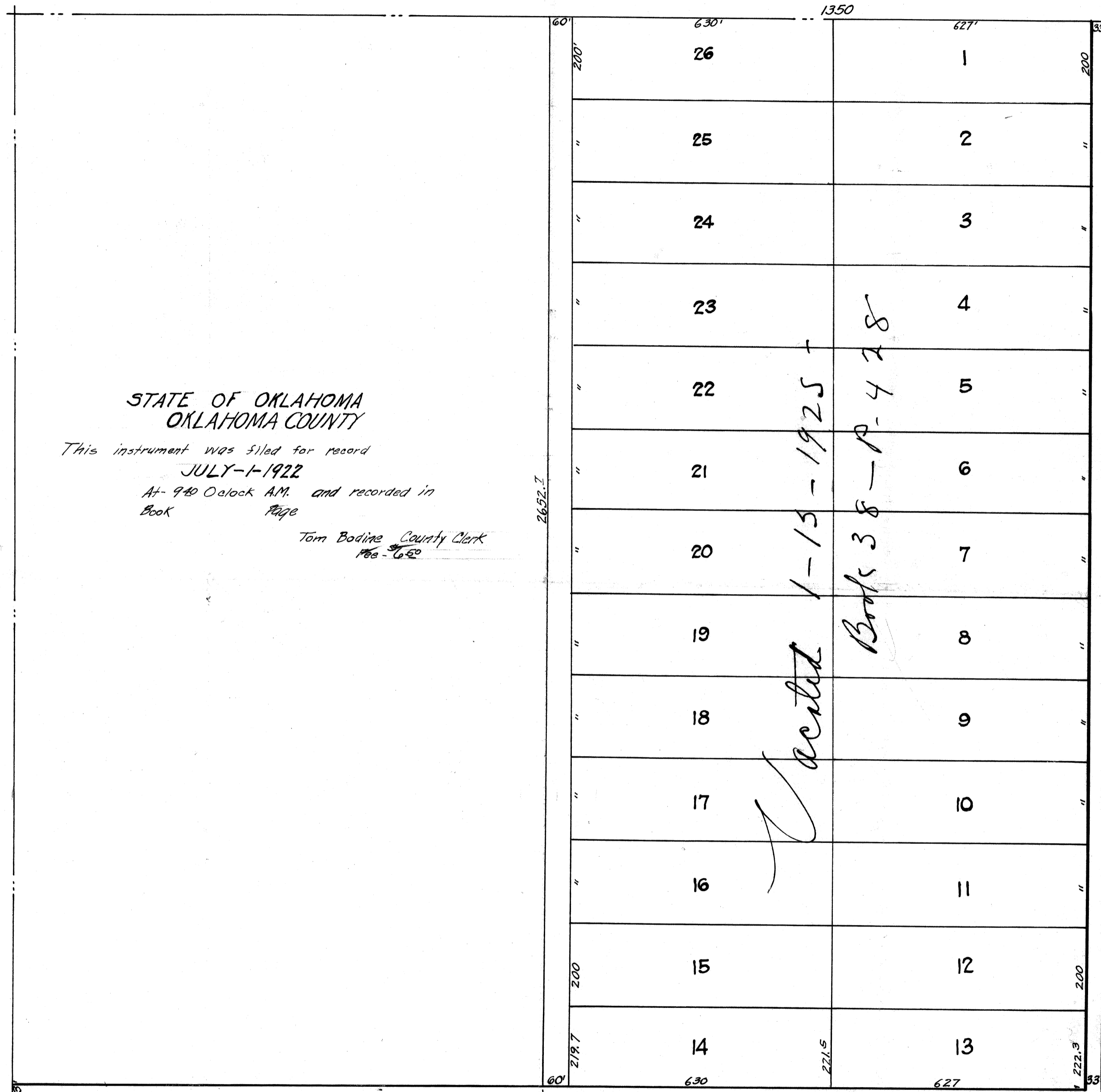

STATE OF OKLAHOMA  
OKLAHOMA COUNTY

This instrument was filed for record  
JULY-1-1922  
At 9:40 O'clock AM. and recorded in  
Book Page

Tom Bodine County Clerk  
Feb 16 1922

KNOW ALL MEN BY THESE PRESENTS:  
That W. B. Armstrong and Phyllis R. Armstrong his wife  
being the owners of the E<sup>1</sup>/<sub>2</sub> of SE<sup>1</sup>/<sub>4</sub> Sec. 6, T. 12N-R. 3W. I.M., more  
particularly described as follows: Beginning at the NE corner  
of SE<sup>1</sup>/<sub>4</sub> Sec. 6, T. 12N-R. 3W. I.M.; thence South along section line 2652.3  
ft; thence West along section line 1350 ft; thence North parallel  
to East section line 2652.1 ft. to North line of SE quarter thence  
East along quarter section line 1350 ft. to place of beginning. Same  
being known as ARMSTRONG ACRES.  
I, H.C. Adams, resident of the County of Oklahoma, hereby  
certify that I am by profession a Civil Engineer, and that at  
the instance of the above named parties I made the above  
subdivision for the plat and that the annexed map or plat is a  
correct representation of the subdivision as made by me.  
Signed this 26 day of May 1922. W. B. Armstrong  
Phyllis R. Armstrong  
Owners

STATE OF OKLAHOMA ss.  
COUNTY OF OKLAHOMA  
Before me, the undersigned, a Notary Public in and for said  
County and State, personally appeared W. B. Armstrong  
and Phyllis R. Armstrong, to me known to be the identical  
persons who executed the within and foregoing instrument and  
acknowledged to me that they executed the same as their  
free and voluntary act and deed, for the uses and purposes

therein set forth. Signed this 26 day of May 1922.  
My Commission expires Sept 10 - 1925  
Edna Southern  
Notary Public.

I, H.C. Adams, resident of the County of Oklahoma, hereby  
certify that I am by profession a Civil Engineer, and that at  
the instance of the above named parties I made the above  
subdivision for the plat and that the annexed map or plat is a  
correct representation of the subdivision as made by me.  
Signed this 25 day of May 1922.  
H.C. Adams  
Civil Engineer

STATE OF OKLAHOMA ss.  
COUNTY OF OKLAHOMA  
Before me, a Notary Public in and for said County and State,  
personally appeared H.C. Adams, to me known to be the identical  
person who executed the within and foregoing instrument, and  
acknowledged to me that he executed the same as his free and  
voluntary act and deed, for the uses and purposes therein set forth.  
Signed this 25 day of May 1922.  
My Commission expires Feb 3 1923.  
Edna Ketch  
Notary Public.

45

67