

6/25
3063

BATH HIGHLAND ADDITION

TERRITORY OF OKLAHOMA } ss.
Oklahoma County.
This instrument was filed for
record this 27 day of
June A.D. 1906
at 4:30 o'clock P.M. and recorded
in Book 6 page 25
J. Smith
Register of Deeds

TO
OKLAHOMA CITY OKLAHOMA

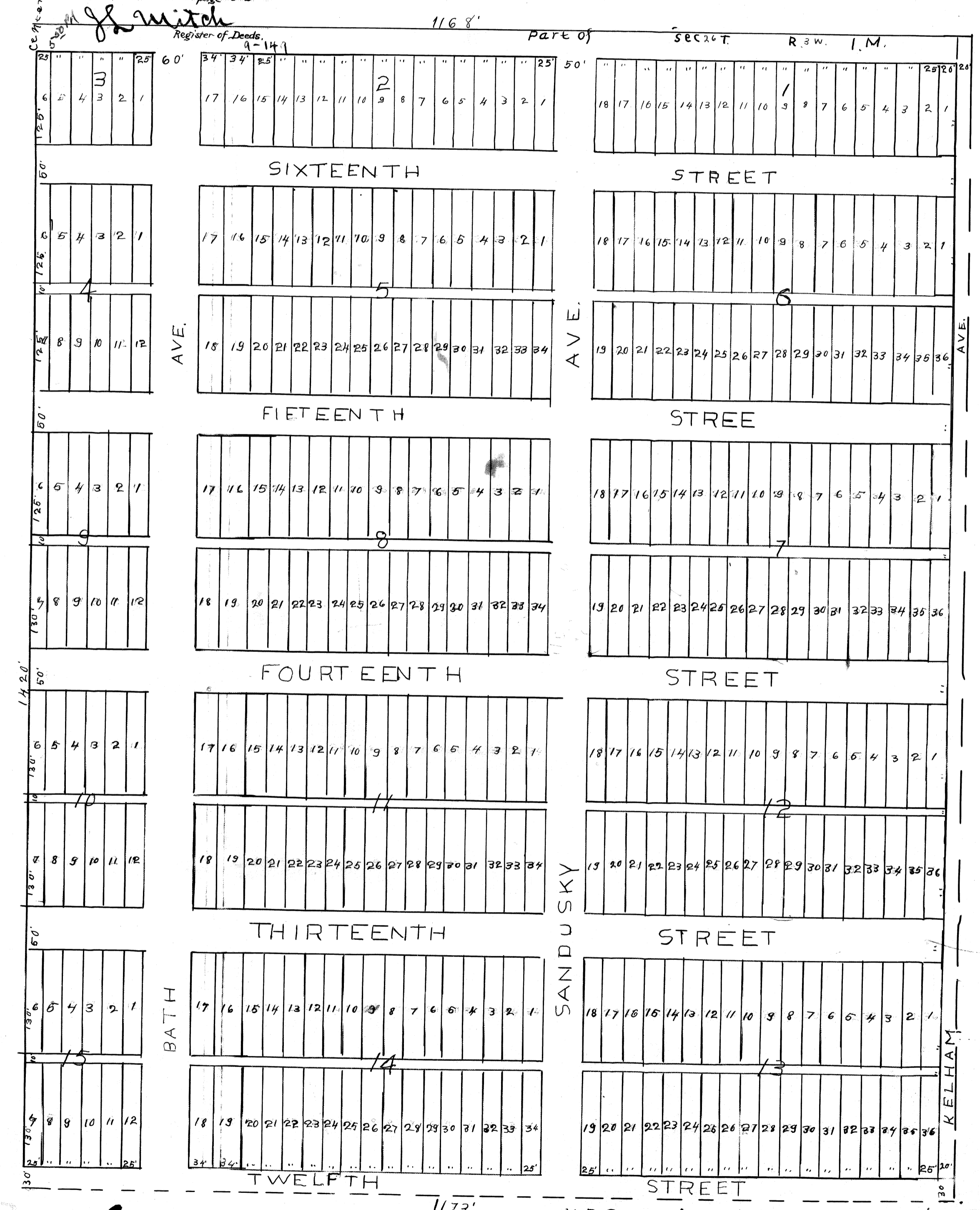
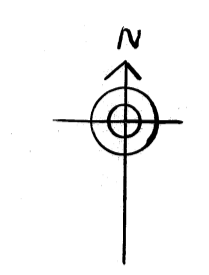

6/25 3063

M.F. Crawford Civil Engineer 736 E. 6th St.
Oklahoma City Oklahoma.

0720
1083

6/25

OWNERS' CERTIFICATE.

BATH HIGHLAND ADDITION TO OKLAHOMA CITY, OKLAHOMA.

Vincent

THIS INSTRUMENT, WITNESSETH: That we, Vincent L. Bath and Sarah K. Bath

That the owners of the land herein described have caused the same to be surveyed into lots, blocks, streets avenues and alleys and we hereby designate and name the same BATH HIGHLAND ADDITION to Oklahoma City, Oklahoma, and we have caused to be made a correct plat of said land.

That the land as surveyed and platted is described and bounded as follows, to-wit:

Beginning at the Northwest corner of Section the South-east quarter of Section Twenty-six (26) in Township Twelve (12) Range Three (3) West T. M.: thence east eleven hundred sixty-eight (1168) feet; thence south fourteen hundred twenty (1420) feet; thence west eleven hundred seventy-three (1173) feet; thence north fourteen hundred twenty (1420) feet to the place of beginning.

WE THEREFORE dedicate to the use of the public the streets and alleys forever.

WITNESS our hands this 27th day of June, 1906.

Vincent L. Bath
Sarah K. Bath

Territory of Oklahoma, Oklahoma County, SS.

Before me J. Lane, a Notary Public in and for Oklahoma County and Oklahoma Territory on this 27th day of June 1906 personally appeared Vincent L. Bath and Sarah K. Bath, husband and wife, to me known to be the identical persons who executed the within and foregoing instrument as their free and voluntary act and deed for the uses and purposes therein set forth.

WITNESS my hand and official seal the day and year above set forth.

J. Lane
Notary Public.

My commission expires July 19, 1909.

6/25 1083

6/25
283

2. $\frac{6}{25}$ ②

I HEREBY CERTIFY that I made the survey in the sub-division of said described land, as shown by the Certificate above, and the size of all lots, width of all streets and alleys, as shown by said plat are true and correct.

I am by profession a Surveyor and Civil Engineer.

WITNESS my hand this 27th day of June 1906.

M. F. Crawford

Territory of Oklahoma, Oklahoma County, SS.

Before me, J. Lane, a notary Public in and for said county and Territory on this 27th day of June, 1906, personally appeared M. F. Crawford, a Civil Engineer, to me known to be the identical person who executed the foregoing certificate and acknowledged that he executed the same as his free and voluntary act and deed for the uses and purposes therein set forth.

WITNESS my hand and notarial seal the day and year above written.

J. Lane
Notary Public.

My commission expires July 19, 1909.

$\frac{6}{25}$ 283

25