

6/61
3083

6/61

BATHS ORCHARD ADDITION

Oklahoma City, Okla.
Scale: 100' = 1"

M. F. Crawford, G. E.
Phone 727 736 East 6th St.

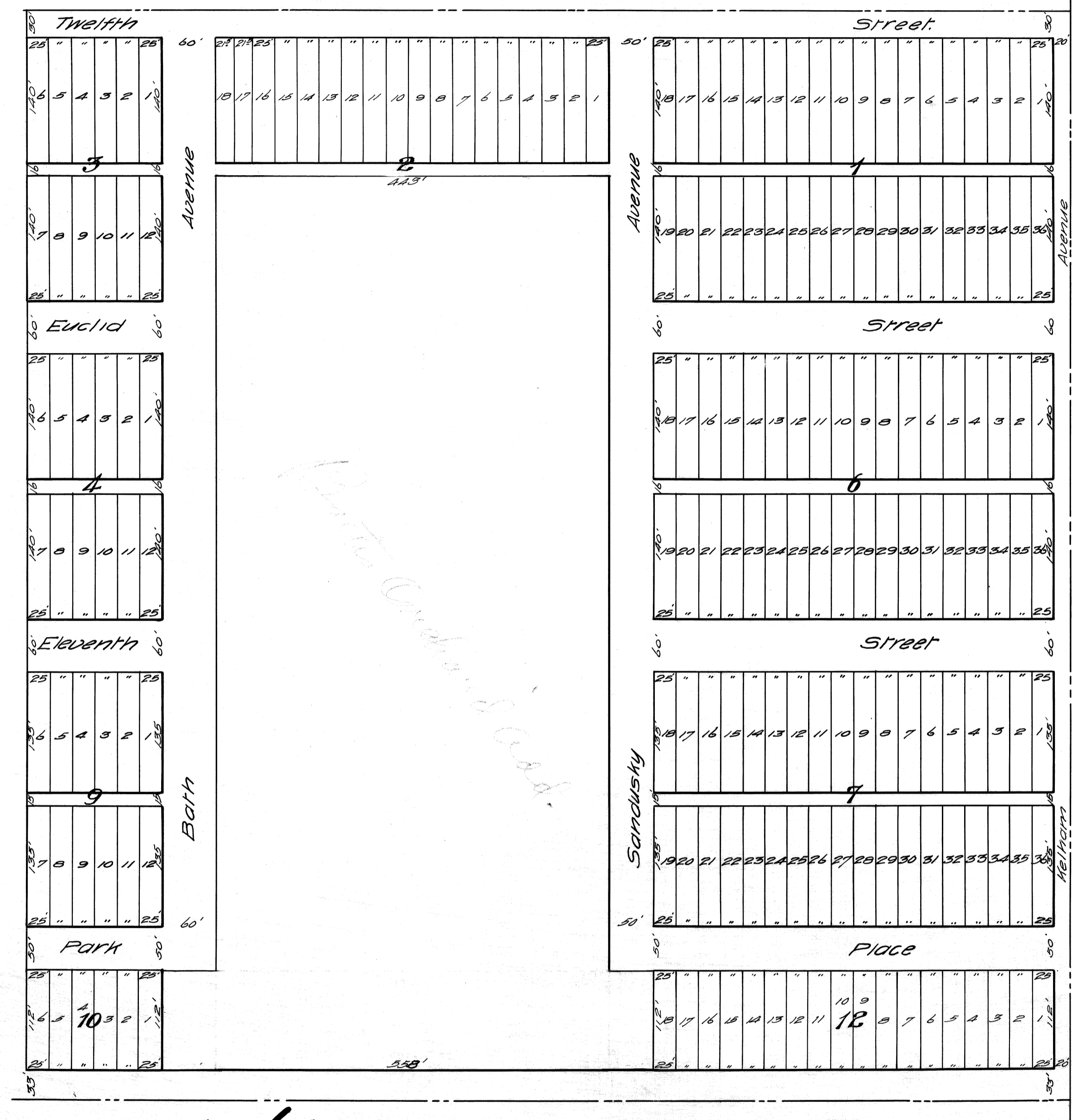
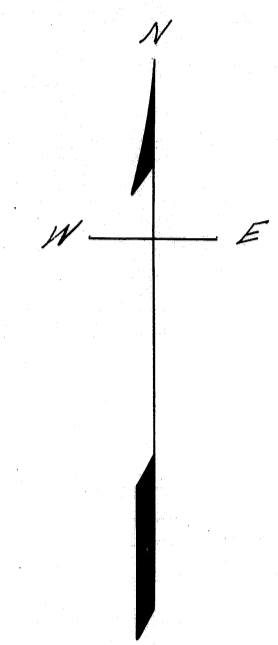

TERRITORY OF OKLAHOMA } ss.
 Oklahoma County,
 This instrument was filed for
 record this 23 day of
 Oct A.D. 1906
 at 3 O'clock, P. M. and recorded
 in Book 6 page 61
 J. L. Mitch
 Register of Deeds.
 9-196
 3-50 yed

6/61 3083

61

6/61
1063

6
61 ①

PLAT OF BATH'S ORCHARD ADDITION

TO

OKLAHOMA CITY, OKLA.

KNOW ALL MEN BY THESE PRESENTS, That we, Vincent L. Bath, and Sarah K. Bath, husband and wife, owners, have caused to be surveyed into lots, blocks, streets and alleys, the following described land in Oklahoma County, Oklahoma, to-wit:

Beginning at the Southwest corner of the Southeast quarter of Section Twenty-six (26) Township Twelve (12), North of Range Three (3) West; running thence north along said Quarter Section 1222 feet; thence east 1173 feet; thence ^{South} parallel with the west line of said Quarter Section ~~1222 feet~~ thence west to the place of beginning, - except a strip described as follows:

Beginning 150 feet East of the South-west corner of said Quarter Section, thence north parallel with the west line of the said Quarter Section 145 feet; thence east with right angle to said west line 60 feet, thence north parallel with said west line 907 feet; thence east at right angles to said west line 443 feet, thence south parallel with said west line 907 feet; thence east at right angles to said west line of Quarter Section 50 feet; thence south 145 feet to the south line of said Quarter Section; thence west along the south line of said Quarter Section 558 feet to the place of beginning, and we hereby adopt the plat set out on the attached sheet as a correct representation of said survey, and name the land as surveyed, BATH'S ORCHARD ADDITION TO OKLAHOMA CITY, OKLAHOMA.

Vincent L. Bath

Sarah K. Bath

Territory of Oklahoma,)
:SS.
Oklahoma County,)

Before me, J. Lane, a Notary Public in and for said County and Territory on this 23rd day of October, 1906, personally appeared Vincent L. Bath and Sarah K. Bath, husband and wife, to me known to be the identical persons who executed the within and foregoing instrument and acknowledged to me (that they executed the same as their free and voluntary act and deed for the uses and purposes therein set forth.

WITNESS my hand and official seal the day and year above set forth.

J. Lane
Notary Public.

My Commission expires July 19, 1909.

6/61 1063

119

6/61
2-003

2.

~~6/61~~ ②

I, Millard F. Crawford, do hereby certify that I am by occupation a Surveyor and Civil Engineer, and that at the instance of Vincent L. Bath and Sarah K. Bath, owners, I surveyed the above described land into blocks, lots, streets and alleys, and said survey is correctly and accurately represented by the map and plat hereto attached.

Dated the 23rd day of October 1906.

Millard F. Crawford
Surveyor.

Territory of Oklahoma,)
) :SS.
County of Oklahoma,)

Before me, J. Lane, Notary Public in and for said County and Territory on this 23rd day of October 1906, personally appeared Millard F. Crawford, to me known to be the identical person who executed the within and foregoing instrument and acknowledged to me that he executed the same as his free and voluntary act and deed for the uses and purposes therein set forth.

WITNESS my hand and official seal the day and year above set forth.

J. Lane
Notary Public.

My Commission expires July 19, 1909.

6/61 283

19