

Book 45
Page 68
Fee \$8.50

BROADWAY SQUARE

PART OF THE SE/4, SEC. 35, T14N-R3W, I.M.
EDMOND, OKLAHOMA COUNTY, OKLAHOMA

OWNER'S CERTIFICATE AND DEDICATION

KNOW ALL MEN BY THESE PRESENTS:

That W.E. Howell & Breene M. Kerr are the owners of all the land included in the Annexed Plat and that they have caused said premises to be surveyed and platted into a block streets, and utility and drainage easements as shown on said plat, which said plat represents a survey of all property included therein, and is hereby adopted as the plat of said land under the name of BROADWAY SQUARE an addition to Edmond, Oklahoma. It does hereby certify that they are the owners of the land and the only person or persons, corporation or corporations, who have any right, title or interest in and to the land included in said plat, and does hereby dedicate all streets and utility and drainage easements shown on said plat to the use of the public as streets and easements for themselves and their successors and assigns, forever, and have caused the same property to be released from all encumbrances and that the title is clear, except as shown in the bonded abstractor's certificate.

In witness whereof, the undersigned, have executed this instrument this 10th day of October, 1973.

W.E. Howell
W.E. Howell
Breene M. Kerr
Breene M. Kerr

THE STATE OF OKLAHOMA ()
COUNTY OF OKLAHOMA () - S.S.

Before me, the undersigned, a notary public in and for said county and state on this the 10th day of October, 1973, personally appeared W.E. Howell & Breene M. Kerr, to me known to be the identical persons who executed the within and foregoing instrument, and acknowledged to me that they executed the same as their free and voluntary act and deed for the uses and purposes therein set forth.

Given under my hand and seal the day and year last above written.

My commission expires 8-15-73
T. Bonded
NOTARY PUBLIC

BONDED ABSTRACTOR'S CERTIFICATE

The undersigned, duly qualified and lawfully bonded abstractor of titles in and for the County of Oklahoma and State of Oklahoma, hereby certify that the records of said county show the title to the land shown on the annexed plat of BROADWAY SQUARE an addition to Edmond, Oklahoma, is vested in W.E. Howell & Breene M. Kerr and that on the 10th day of October, 1973, there were no actions or judgments of any nature in any court or on the records with the clerk of any court in said county and state against said lands or the owner's thereof; that the taxes are paid for the year 1973, and prior years, and that no tax sales certificates are against said land and no tax deeds are issued to any person or persons, and that there are no liens, mortgages or encumbrances of any kind against the land described on the annexed plat; except oil and gas leases, and mineral conveyances and easements of record, and mortgage to Fidelity Bond, National Bank.

Signed and sealed at Okla. City, Oklahoma, this 10th day of October, 1973.

ATTEST: SOUTHWEST TITLE & TRUST COMPANY
Charles Whomble (TITLE) Assistant Secretary
E. D. Wall (TITLE) Vice President

CERTIFICATE OF CITY CLERK

I, W.B. Bryan, Clerk of the City of Edmond, State of Oklahoma, hereby certify that I have examined the records of said city and find that all deferred payments or unamortized installments upon special assessments have been paid in full and that there is no special assessment procedure now pending against the land as shown on the annexed plat of BROADWAY SQUARE, an Addition to Edmond, Oklahoma, on the 13th day of December, 1973.

W.B. Bryan
CITY CLERK

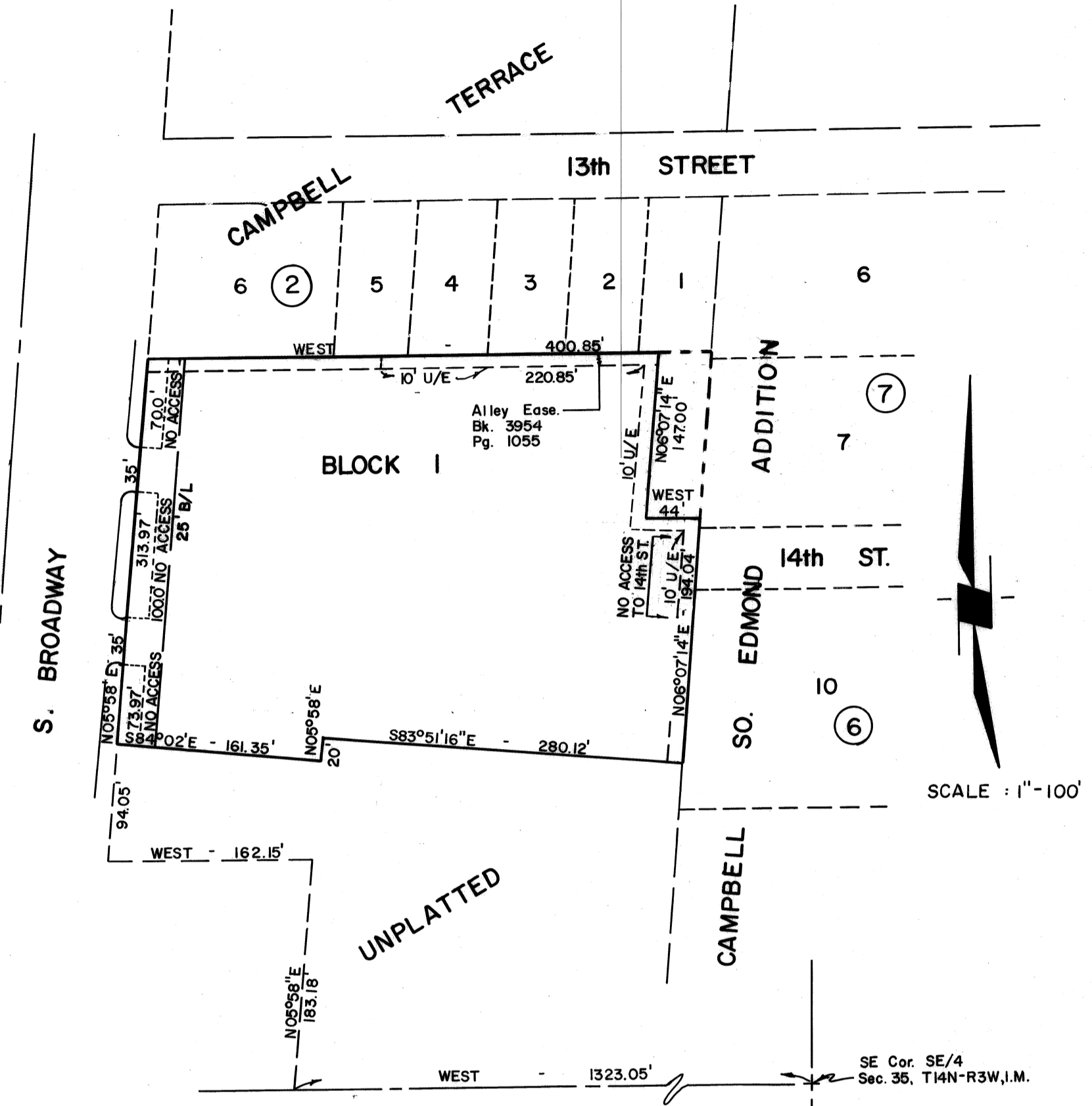

ACCEPTANCE OF DEDICATION BY CITY COUNCIL
Be it resolved by the Council of the City of Edmond, Oklahoma, that the dedications shown on the annexed plat of BROADWAY SQUARE an Addition to Edmond, Oklahoma, are hereby accepted.

Adopted by the Council of the City of Edmond, Oklahoma, this 18th day of June, 1973.
Adopted by the Mayor of the City of Edmond, Oklahoma, this 18th day of June, 1973.
ATTEST: *W.B. Bryan* CITY CLERK
Johnny L. Green MAYOR

COUNTY TREASURER'S CERTIFICATE
I, Jack Blackwell, do hereby certify that I am the duly elected, qualified and acting county treasurer for Oklahoma County, State of Oklahoma; that the tax records show all taxes are paid for the year 1973, and prior years, on the land shown on the annexed plat of BROADWAY SQUARE, an Addition to Edmond, Oklahoma, that the required statutory security has been deposited in the office of the county treasurer guaranteeing payment of the current year's taxes.
In witness whereof, said county treasurer has caused this instrument to be executed at Okla. City, Oklahoma, on this the 14th day of December, 1973.

By *Martin Johnson* Chief Deputy
Jack Blackwell COUNTY TREASURER

PLANNING COMMISSION CERTIFICATE
PLANNING COMMISSION APPROVAL: I, Max O. Davis, Chairman/Secretary of the Planning Commission for the City of Edmond, State of Oklahoma, hereby certify that the said Commission duly approved the annexed plat of BROADWAY SQUARE an Addition to Edmond, Oklahoma, on the 12th day of June, 1973.

Max O. Davis
Chairman/Secretary

SURVEYOR'S CERTIFICATE
I, Leslie Judd, Jr., do hereby certify that I am by profession a registered land surveyor and that the annexed plat of BROADWAY SQUARE, an Addition to Edmond, Oklahoma, consisting of one (1) sheet, correctly represents a survey made under my supervision on the 18th day of May, 1973, and all monuments shown hereon actually exist and their positions are correctly shown.

Leslie Judd, Jr.
REGISTERED LAND SURVEYOR
OKLAHOMA

THE STATE OF OKLAHOMA () S.S.
COUNTY OF OKLAHOMA ()

Before me, the undersigned, a notary public in and for said County and State, on this 16th day of May, 1973, personally appeared Leslie Judd, Jr., to me known to be the identical person who executed the within and foregoing instrument, and acknowledged to me that he executed the same as his free and voluntary act and deed for the uses and purposes therein set forth.

Given under my hand and seal the day and year last above written.
My commission expires: September 30, 1973
A. J. Dreyer
NOTARY PUBLIC

LAND SURVEYOR'S CERTIFICATE

I, Donald J. Cunningham, do hereby certify that I am by profession a registered professional engineer and land surveyor, and that the annexed plat of BROADWAY SQUARE an addition to Edmond, Oklahoma, consisting of one sheet correctly represents a survey made under my supervision on the 18th day of May, 1973, and that all monuments shown hereon actually exist and their positions are correctly shown.

Donald J. Cunningham
DONALD J. CUNNINGHAM, Reg. No. 7316
L.S. No. 477

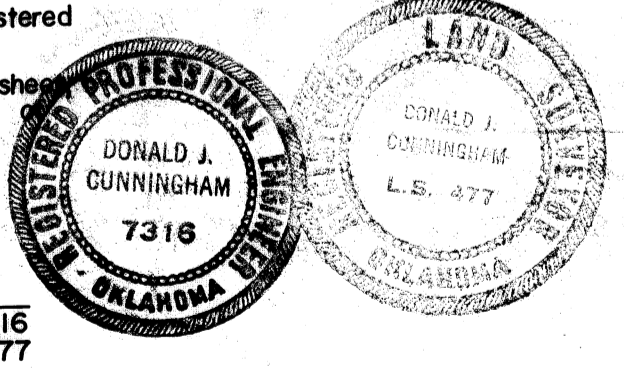

PLAN & SURVEY BY
R.W. THOMAS SURVEYING CO.
329 NW 3rd Street Phone: 236-4333
OKLAHOMA CITY, OKLAHOMA

Book 45 Page 68