

Book 50
Page 55
Fee 25.00

STATE OF OKLAHOMA
COUNTY OF HARRAH

OWNER'S CERTIFICATE & DEDICATION

KNOW ALL MEN BY THESE PRESENTS
THAT WE, THE UNDERSIGNED, BRUSH CREEK DEVELOPMENT CO., LTD., AN OKLAHOMA LIMITED PARTNERSHIP, DO HEREBY CERTIFY THAT WE ARE THE OWNERS OF AND THE ONLY PERSON OR PERSONS, CORPORATION OR CORPORATIONS, HAVING ANY RIGHT, TITLE, OR INTEREST IN THE LAND SHOWN ON THE ANNEXED PLAT OF BRUSH CREEK, SECTION 1, BEING A PART OF NE 1/4, SECTION 35, T-12-N, R-1-E, HARRAH, OKLAHOMA COUNTY, OKLAHOMA, AND HAVE CAUSED THE SAID PREMISES TO BE SURVEYED AND PLATTED INTO LOTS, BLOCKS, STREETS, AND EASEMENTS AS SHOWN ON SAID ANNEXED PLAT, WHICH SAID ANNEXED PLAT REPRESENTS A CORRECT SURVEY OF ALL PROPERTY INCLUDED THEREIN AND IS HEREBY ADOPTED AS THE PLAT OF LAND UNDER THE NAME OF BRUSH CREEK, SECTION 1, BRUSH CREEK DEVELOPMENT CO., LTD., AN OKLAHOMA LIMITED PARTNERSHIP, DOES HEREBY DEDICATE ALL STREETS AND EASEMENTS SHOWN ON SAID ANNEXED PLAT TO THE PUBLIC FOR PUBLIC HIGHWAYS, STREETS, AND EASEMENTS FOR THEMSELVES, THEIR SUCCESSORS AND ASSIGNS FOREVER AND HAVE CAUSED THE SAME TO BE RELEASED FROM ALL RIGHTS, EASEMENTS AND ENCUMBRANCES EXCEPT AS SHOWN IN THE BONDED ABSTRACTER'S CERTIFICATE

BRUSH CREEK SECTION 1
BEING A PART OF NE 1/4, SEC. 35, T12N, R1E
HARRAH, OKLAHOMA COUNTY, OKLAHOMA

LEGAL DESCRIPTION
BEING A PART OF NE 1/4 OF SECTION 35, T12N, R1E, HARRAH, OKLAHOMA COUNTY, OKLAHOMA, MORE PARTICULARLY DESCRIBED AS FOLLOWS, BEGINNING AT A POINT S 89° 47' 16" E, 450 00' FROM THE NW CORNER OF NE 1/4 OF SAID SECTION,
THENCE S 89° 47' 16" E A DISTANCE OF 1060 00'
THENCE S 0° 12' 44" W A DISTANCE OF 215 00'
THENCE S 25° 53' 33" E A DISTANCE OF 429 00'
THENCE S 64° 06' 27" W A DISTANCE OF 340 88'
THENCE S 42° 30' 17" E A DISTANCE OF 387 77'
THENCE S 37° 17' 09" E A DISTANCE OF 353 18'
THENCE N 89° 50' 17" W A DISTANCE OF 639 00'
THENCE N 0° 15' 52" E A DISTANCE OF 150 54'
THENCE N 89° 47' 16" W A DISTANCE OF 75 00'
THENCE N 0° 15' 52" E A DISTANCE OF 646 92'
THENCE N 89° 47' 16" W A DISTANCE OF 26 39'
THENCE N 0° 15' 52" E A DISTANCE OF 140 00'
THENCE N 89° 47' 16" W A DISTANCE OF 231 67'
THENCE N 0° 15' 52" E A DISTANCE OF 140
THENCE N 89° 47' 16" W A DISTANCE OF 22
THENCE N 0° 15' 52" E A DISTANCE OF 22
CONTAINS 27 19 ACRES TO THE POINT OF BEGINNING

CERTIFICATE OF CITY CLERK
I, Irene Burrows, CITY CLERK OF THE CITY OF HARRAH, STATE OF OKLAHOMA, HEREBY CERTIFY THAT I HAVE EXAMINED THE RECORDS OF SAID CITY AND FIND ALL DEFERRED PAYMENTS OR UNMATURED INSTALLMENTS UPON SPECIAL ASSESSMENTS HAVE BEEN PAID IN FULL AND THERE IS NO SPECIAL ASSESSMENT PROCEDURE NOW PENDING AGAINST THE LAND AS SHOWN ON THE ANNEXED PLAT OF BRUSH CREEK, SECTION 1, HARRAH, OKLAHOMA COUNTY, OKLAHOMA, ON THE 2nd DAY OF April, 1981

IN WITNESS WHEREOF THE UNDERSIGNED HAVE CAUSED THIS INSTRUMENT TO BE EXECUTED THIS 27 DAY OF April, 1981

BRUSH CREEK DEVELOPMENT CO., LTD.,
AN OKLAHOMA LIMITED PARTNERSHIP
W.P. Atkinson II
W P ATKINSON II, GENERAL PARTNER

STATE OF OKLAHOMA
COUNTY OF Oklahoma

BEFORE ME, THE UNDERSIGNED, A NOTARY PUBLIC IN AND FOR SAID COUNTY AND STATE, ON THIS 29 DAY OF April, 1981, PERSONALLY APPEARED **W.P. Atkinson II** TO ME KNOWN TO BE THE IDENTICAL PERSON WHO SIGNED THE NAME OF THE MAKER TO THE WITHIN AND FOREGOING INSTRUMENT AND ACKNOWLEDGED TO ME THAT HE EXECUTED THE SAME AS HIS FREE AND VOLUNTARY ACT AND DEED FOR THE USES AND PURPOSES THEREIN SET FORTH

GIVEN UNDER MY HAND AND SEAL THE DAY AND YEAR LAST ABOVE WRITTEN
MY COMMISSION EXPIRES April 16 1984
Maureen
NOTARY PUBLIC

BONDED ABSTRACTER'S CERTIFICATE

THE UNDERSIGNED, DULY QUALIFIED AND LAWFULLY BONDED ABSTRACTER OF TITLES IN AND FOR THE COUNTY OF OKLAHOMA AND STATE OF OKLAHOMA, HEREBY CERTIFIES THAT THE RECORDS OF SAID COUNTY SHOW THE TITLE TO THE LAND SHOWN ON THE ANNEXED PLAT OF BRUSH CREEK, SECTION 1, HARRAH, OKLAHOMA COUNTY, OKLAHOMA, IS VESTED IN BRUSH CREEK DEVELOPMENT CO., LTD., AN OKLAHOMA LIMITED PARTNERSHIP, AND THAT ON THE 14th DAY OF May, 1981, THERE ARE NO LIENS, MORTGAGES OR ENCUMBRANCES OF ANY KIND AGAINST THE LAND DESCRIBED ON THE ANNEXED PLAT, EXCEPT MINERAL CONVEYANCES AND EASEMENTS AND MORTGAGES ON RECORD SIGNED AND SEALED AT Oklahoma City, OKLAHOMA, THIS 12th DAY OF May, 1981

ATTEST
Beth arnitchman ASSISTANT SECRETARY
Edward A. Dennis VICE-PRESIDENT

STATE OF OKLAHOMA
COUNTY OF OKLAHOMA

BEFORE ME, A NOTARY PUBLIC IN AND FOR SAID COUNTY AND STATE, PERSONALLY APPEARED **Edward A. Dennis**, TO ME KNOWN TO BE THE IDENTICAL PERSON WHO EXECUTED THE ABOVE INSTRUMENT AS ITS VICE PRESIDENT AND ACKNOWLEDGED TO ME THAT HE EXECUTED THE SAME AS HIS FREE AND VOLUNTARY ACT AND DEED FOR THE USES AND PURPOSES THEREIN SET FORTH

WITNESS MY HAND AND SEAL THIS 10th DAY OF May, 1981

COMMISSION EXPIRES
July 20, 1983

Renae Rose
NOTARY PUBLIC

NW Cor N1/2 NE 1/4
Sec 35, T12N, R1E



CURVE DATA					
CURVE NO	Δ	D	T	R	L
1	26°06'17"	13 28 29	100 00	431 35	196 53
2	42°42'51"	17 22 15	130 10	332 70	248 03
3	26°06'11"	33 56 74	39 57	170 69	77 76

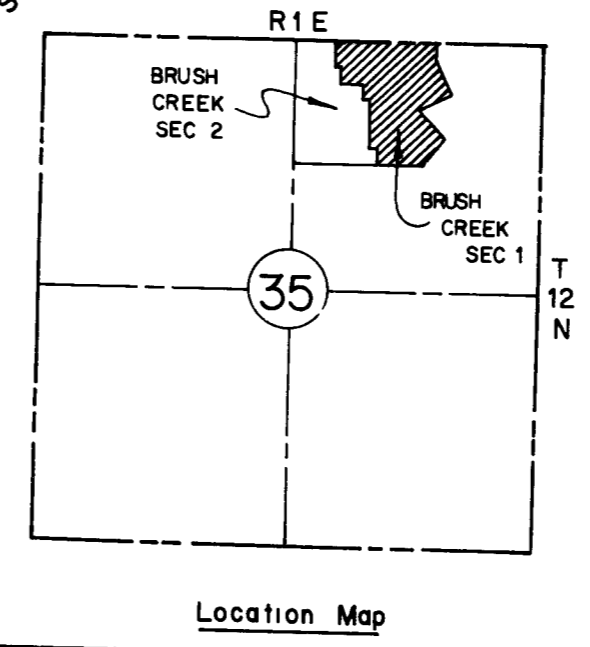

SCALE 1" = 2000

ACCEPTANCE OF DEDICATION BY CITY COUNCIL
BE IT RESOLVED BY THE CITY COUNCIL OF THE CITY OF HARRAH, THAT THE DEDICATIONS SHOWN ON THE ANNEXED PLAT OF BRUSH CREEK, SECTION 1, HARRAH, OKLAHOMA, ARE HEREBY ACCEPTED
ADOPTED BY THE CITY COUNCIL OF THE CITY OF HARRAH ON THIS 2nd DAY OF April, 1981

Irene Burrows CITY CLERK
Robert L. Maffey MAYOR

COUNTY TREASURER'S CERTIFICATE
I, **Joe B. Barnes**, DO HEREBY CERTIFY THAT I AM THE DULY ELECTED, QUALIFIED AND ACTING COUNTY TREASURER FOR OKLAHOMA COUNTY, STATE OF OKLAHOMA, THAT THE TAX RECORDS SHOW ALL TAXES ARE PAID FOR THE YEAR 1980, AND PRIOR YEARS, ON THE LAND SHOWN ON THE ANNEXED PLAT OF BRUSH CREEK, SECTION 1, HARRAH, OKLAHOMA COUNTY, OKLAHOMA, THAT THE REQUIRED STATUTORY SECURITY HAS BEEN DEPOSITED IN THE OFFICE OF THE COUNTY TREASURER GUARANTEEING PAYMENT OF THE CURRENT YEAR'S TAXES IN WITNESS WHEREOF, SAID COUNTY TREASURER HAS CAUSED THIS INSTRUMENT TO BE EXECUTED AT OKLAHOMA CITY, OKLAHOMA, ON THIS 1st DAY OF May, 1981

Joe B. Barnes COUNTY TREASURER

PLANNING COMMISSION CERTIFICATE
PLANNING COMMISSION APPROVAL I, **Gary P. Mixon**, CHAIRMAN/ SECRETARY OF THE PLANNING COMMISSION FOR THE CITY OF HARRAH, STATE OF OKLAHOMA, HEREBY CERTIFY THAT THE SAID COMMISSION DULY APPROVED THE ANNEXED PLAT OF BRUSH CREEK, SECTION 1, HARRAH, OKLAHOMA COUNTY, OKLAHOMA, ON THE 12th DAY OF March, 1981

Gary P. Mixon CHAIRMAN/SECRETARY

SURVEYOR'S CERTIFICATE
I, **DEARL B. STOUT**, A REGISTERED LAND SURVEYOR IN AND FOR THE STATE OF OKLAHOMA, DO HEREBY CERTIFY THAT A CAREFUL SURVEY WAS MADE UNDER MY SUPERVISION OF A PART OF NE 1/4 OF SECTION 35, T12N, R1E, HARRAH, OKLAHOMA COUNTY, OKLAHOMA, AS SHOWN ON THE ATTACHED PLAT OF BRUSH CREEK SECTION 1, HARRAH, OKLAHOMA COUNTY, OKLAHOMA

Dearl B. Stout DEARL B STOUT L S #240

STATE OF OKLAHOMA
COUNTY OF CLEVELAND
BEFORE ME, A NOTARY PUBLIC IN AND FOR SAID COUNTY AND STATE, PERSONALLY APPEARED **DEARL B. STOUT**, TO ME KNOWN TO BE THE IDENTICAL PERSON WHO EXECUTED THE ABOVE INSTRUMENT AND ACKNOWLEDGED TO ME THAT HE EXECUTED THE SAME AS HIS FREE AND VOLUNTARY ACT AND DEED FOR THE USES AND PURPOSES THEREIN SET FORTH
WITNESS MY HAND AND SEAL THIS 9th DAY OF April, 1981

MY COMMISSION EXPIRES 4-20-83
Louis A. Miller NOTARY PUBLIC

SETTLE & SPEAR ENGINEERS, INC
OKLAHOMA CITY, OKLAHOMA

Book 50 p. 55