

Territory of Oklahoma } ss.  
Oklahoma County }  
This instrument was  
filed for record  
of this day  
of July A.D. 1901  
at 11:17 A.M. and recorded  
Page  
776  
of  
J. P. Bowman  
Deputy  
Register of Deeds

# COLLEGE HILL ADDITION

To Oklahoma City O.T.

Being the S.W. 1/4 of section 9, 11 N. 23 W. 1 M.

Scale 250' = 1"

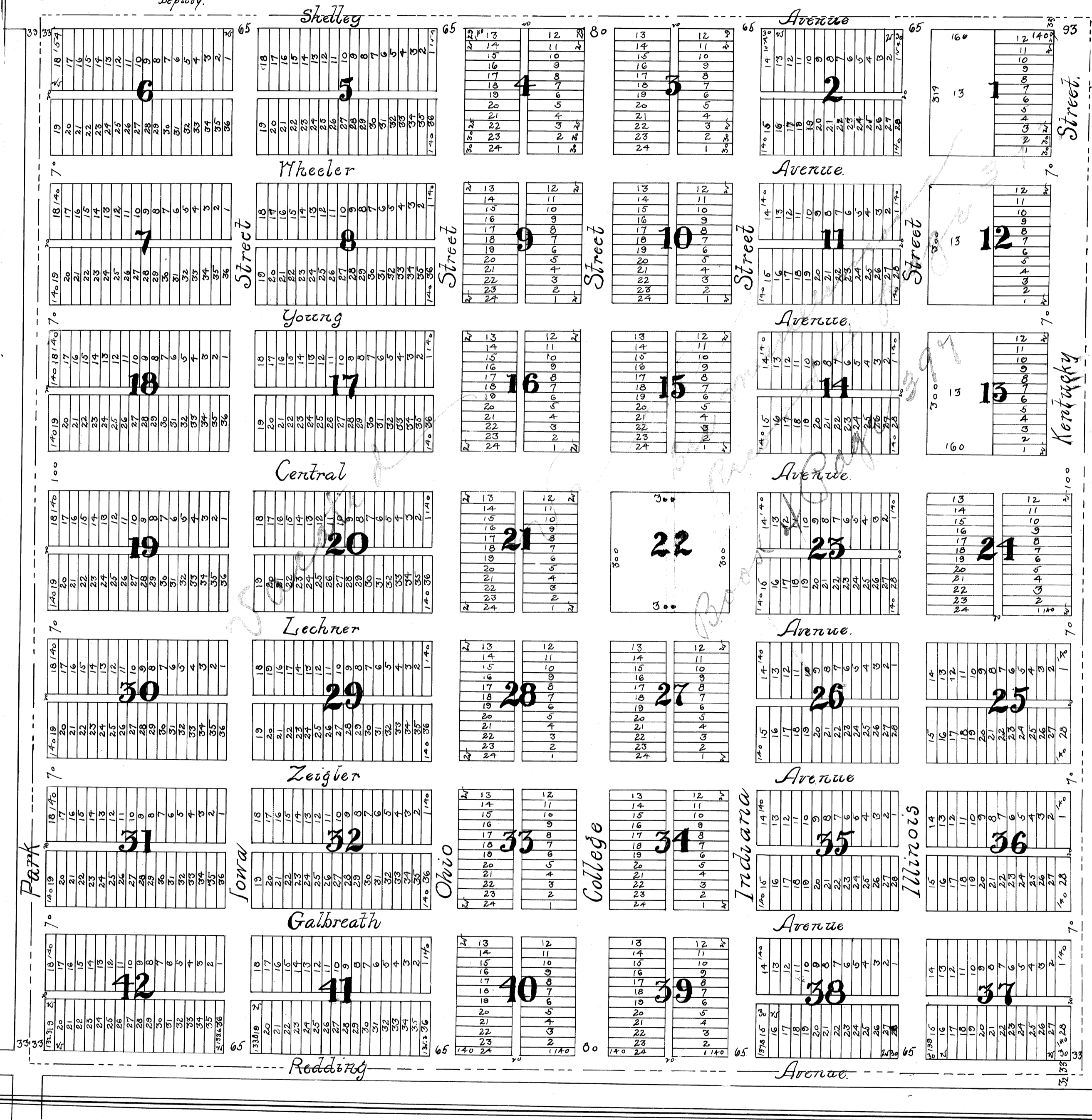

2/39

4/39

### Surveyors Certificate

I hereby certify that the plat hereto attached is a true exemplification of the work done on the ground in the Survey of the S.W. 1/4 of Section 9 in Township 11 North of Range 3 West 11th and that the size of all lots and blocks and width of all streets and alleys as shown by said plat are correct.

Oklahoma City, July 1st 1901.

J. P. Barnard  
County Surveyor.

Territory of Oklahoma } ss.  
Oklahoma County }

This is to certify that I, James H. Wheeler, as owner of the land hereinafter described have caused the same to be surveyed into lots, blocks, avenues, streets and alleys and do hereby designate the same as a townsite, to be known as College Hill addition to Oklahoma City and that the land platted and surveyed as such townsite is located in Oklahoma County, Territory of Oklahoma and described as follows, to-wit: - The South West Quarter of Section 9 in Township 11 North of Range 3 West of the Indian Meridian and that I do hereby dedicate the Avenues, Streets, Alleys to public use.

Witness my hand, this 2nd day of July 1901.  
James H. Wheeler

Territory of Oklahoma } ss.  
Oklahoma County }

Before me O. H. Everett a notary public in and for said County and Territory, personally appeared James H. Wheeler, owner of the above described lands and J. P. Barnard surveyor, who are known to me to be the identical persons who signed the foregoing certificates, and they and each of them for himself acknowledged that they executed the same as their free and voluntary act for purposes therein set forth.

Witness my hand and Notarial Seal, this 2nd day July 1901.  
O. H. Everett,  
Notary Public.  
Commission expires March 29th 1903.