

6/29

29

Book 6 Page 29

Eggleston's
 Subdivision Of
 Part of Block 5 Eggleston's Addition
 and
 North Half of Block 4 Schilling Addition
 to
 Oklahoma City Okla

Scale: 1 in = 100 ft

Territory of Oklahoma } ss.
Oklahoma County }

This instrument witnesses that we Ella D. Eggleston & Clarence H. Eggleston, the owners of the East One hundred fifty feet (150') of Block Five (5) Eggleston's Addition to Oklahoma City, Okla. and Henry Lambert, single, Wm. H. Defferding and Amelia Defferding, his wife, owners of the North half of Block Four (4) Schilling Addition to Oklahoma City, Okla. have caused the same to be replatted into lots and alleys and we hereby designate and name the same as follows: Subdivision of Part of Block Five Eggleston's Addition to Oklahoma City and North half of Block Four Schilling Addition to Oklahoma City, Okla. That we have caused the same to be made as platted and we hereby dedicate the alleys, shown on said plat, to the public forever.

Witness our hands this 18 day of July 1906.

Ella D. Eggleston
 Clarence H. Eggleston
 Henry Lambert
 Wm. H. Defferding
 Amelia Defferding

Territory of Oklahoma } ss.
Oklahoma County }

Be it known to all men that before me J. L. Mitch a Notary Public in and for said County and Territory, personally appeared Ella D. Eggleston and Clarence H. Eggleston her husband, Henry Lambert and Amelia Defferding, his wife, to me known to be the identical persons who executed the foregoing instrument and acknowledged to me that they executed the same as their free and voluntary act and deed for the uses and purposes therein set forth.

Witness my hand and official seal this 18 day of July 1906.

My commission expires April 16, 1910 J. L. Mitch

TERRITORY OF OKLAHOMA } ss.
Oklahoma County }

This instrument was filed for record this 19th day of July A.D. 1906. at 9:25 o'clock A.M. and recorded in Book 6 page 29

J. L. Mitch
 Register of Deeds.
 \$4.00 9-1906

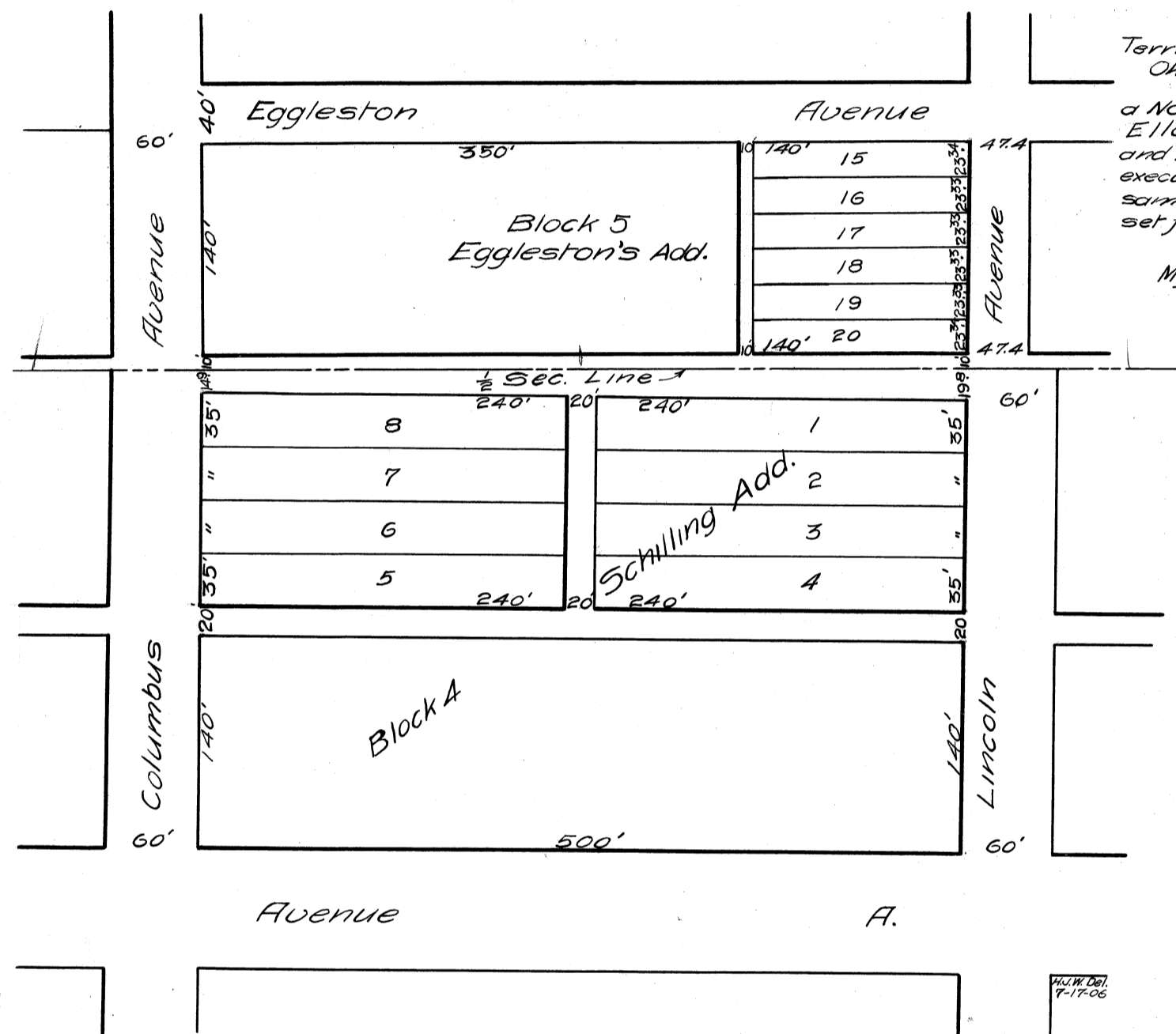

6/29