

102
2

DRAWING NUMBER
8/46
PLAN HOLD CORPORATION • IRVINE, CALIFORNIA
REORDER BY NUMBER 075AR

DRAWING NUMBER
PLAN HOLD CORPORATION • IRVINE, CALIFORNIA
REORDER BY NUMBER 075AR

ETHEL PARK PLACE ADDITION

adjoining

OKLAHOMA CITY, OKLA.

*Being
Part of the North-West Quarter of the South-East Quarter of Section 25*

Township 12 North - Range 5 West

Scale: 1 in. = 100 ft.

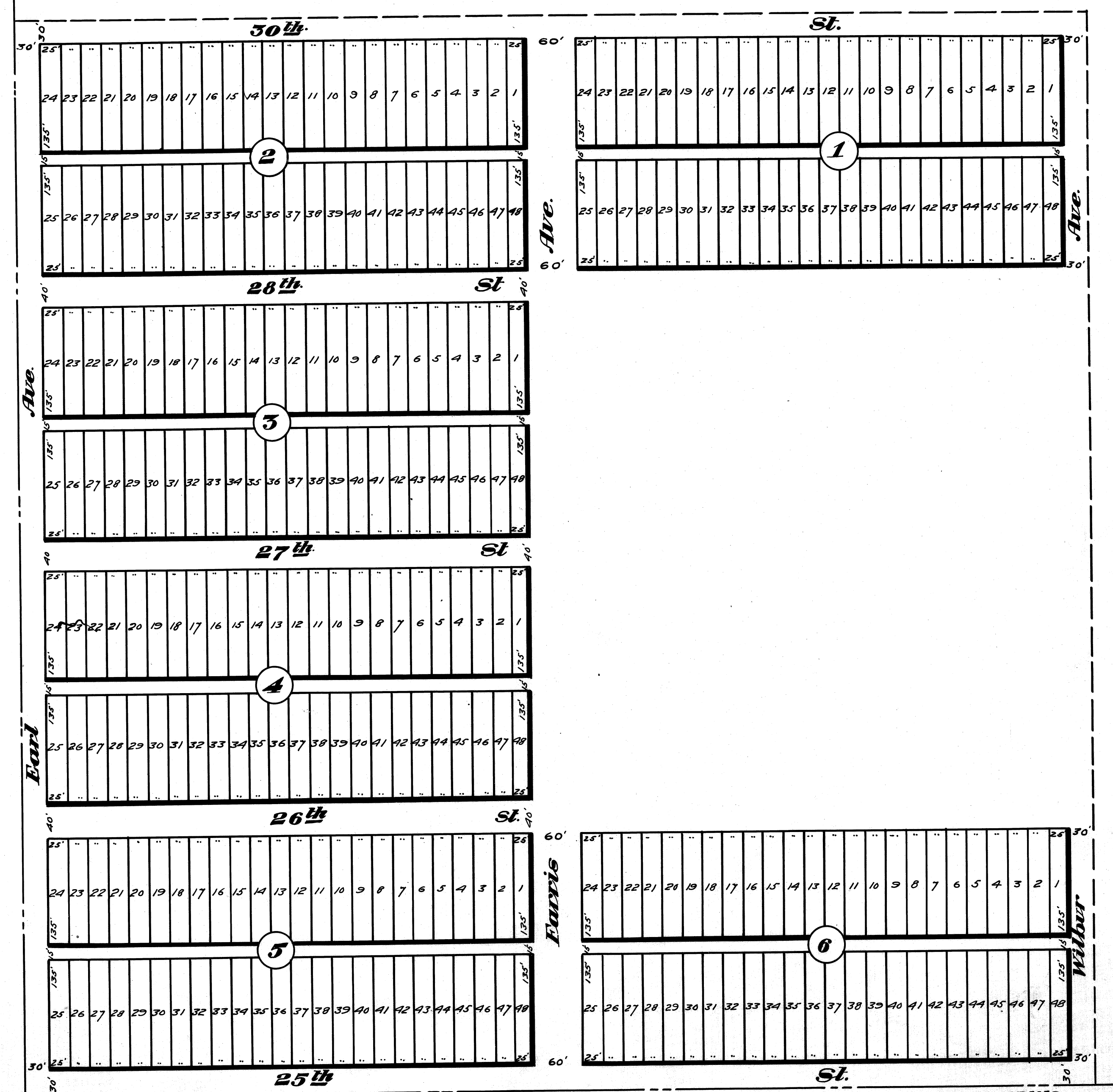

BENHAM & ADAMS
Civil Engineers
OKLAHOMA CITY, OKLA. 5/19/47

Lot 7

8/46

KNOW ALL MEN BY THESE PRESENTS that we, J. W. TEAM and wife Edith M. Team, the owners of the following described real estate situated in the County of Oklahoma, Territory of Oklahoma, to wit:- The west 1/2 of The N. W. 1/4 of the S. E. 1/4 of Section 23, Township 12 North, Range 3 West I. M. and that part of same section as shown on the annexed sheet:- have caused the above mentioned land to be subdivided into lots, streets and alleys, and which subdivision do designate and name ETHEL PARK PLACE ADDITION to Oklahoma, and that a correct map of said land is set out on the annexed sheet.

Signed this 1st day of July 1907.

Edith M. Team
J. W. Team
Owners.

Territory of Oklahoma, }
County of Oklahoma. } SS

Before me, Henry C. Sider a Notary Public, in and for said County and Territory, on this 1st day of July 1907, personally appeared J. W. Team and wife Edith M. Team, to me known to be the identical persons who executed the foregoing instrument, and acknowledged to me that they executed the same as their free and voluntary act and deed for the uses and purposes therein set forth.

WITNESS my hand and official seal, the day and year above set forth.

Henry C. Sider
Notary Public.

My commission expires Nov 24 1907

We, W. L. Benham and H. C. Adams, residents of Oklahoma City, County of Oklahoma, Territory of Oklahoma, hereby certify that we are by profession Civil Engineers, and that at the instance of J. W. Team and wife Edith M. Team we made a survey of the above described real estate, and that a correct map or plat of said land as surveyed by us is set out on the annexed sheet.

Signed this 1 day of July 1907.

W. L. Benham
H. C. Adams
Civil Engineers.

Territory of Oklahoma, }
County of Oklahoma. } SS

Before me, Pearle P. West a Notary Public, in and for said County and territory, on this 1 day of July 1907, personally appeared W. L. Benham and H. C. Adams, to me known to be the identical persons who executed the foregoing instrument and acknowledged to me that they executed the same as their free and voluntary act and deed for the uses and purposes therein set forth.

WITNESS my hand and official seal, the day and year above set forth.

Pearle P. West
Notary Public.

My commission expires July 31 1910.

TERRITORY OF OKLAHOMA, }
Oklahoma, County. }

This instrument was filed
record this 8 day of
July A. D. 1907
at 4 o'clock P. M. and recorded
on page 46

\$ 50 pd. J. L. Mitch
Register of Deeds

46-97