

Know all men by These Presents.

That the Classen Co. a corporation, the owner of the land hereinafter described, has caused the same to be re-surveyed and re-subdivided into lots, streets and alleys, that such survey and re-subdivision is correctly shown and represented by this amended Plat of Fays addition to Oklahoma City, and the map thereof set out on this sheet; that the streets and alleys shown on this plat and map are hereby dedicated to public use, subject however to the following provisions, to-wit; That the thirty feet of Fourteenth street lying adjacent to said block as herein shown shall be divided into three strips of ground, ten feet wide lying along the entire length of said block of which the center strip shall be used for sidewalk and the two other strips shall be used for parking, all as indicated on said map. That the property hereby platted is described as follows, to-wit; Lots numbered 1, 2, 16, 17, 18, 19, 20, 21, 22, 23, 24, 25, 26, 27, 28, 29, 30, 31, 32, 33, 34, 35, 36, 27, 38, 39, 40, 41, 42, 43 and 44, in Fays addition to Oklahoma City, as shown by the original plat of said addition recorded in Book 2 of Plats on page 2 of the Records in the office of the Register of Deeds of said County. That Lots 3 to 15 inclusive in said addition are not the property of the Classen Co. and are in no wise changed or affected by this amended Plat, but Lots 1, 2, 36, 37 and the south 50 feet of Lots 38, 39, 40, 41, 42, 43 and 44 are hereby made front of 14th Street. It is hereby especially provided no building of any kind shall be erected on the south 30 feet of Lots Thirty to Forty Three, inclusive or any of them, as shown by this plat, said thirty feet to be used for lawn and park only, except that the front porch of any building may extend south across said building line not to exceed eight feet.

Dated this 24th day of April 1902.

The Classen Co.
by Geo. E. Gardner Pres't

Attest: Geo. H. Brauer
Secretary

Territory of Oklahoma, Oklahoma County, S.S.

Before me, a Notary Public in and for said County and Territory, on this 24th day of April, 1902, personally appeared Geo. E. Gardner, to me known to be the identical person who signed the name of the maker thereof to the above and foregoing instrument as its President and acknowledged to me that he executed the same as his free and voluntary act and deed, and as the free and voluntary act and deed of said corporation for the uses and purposes therein set forth.

Witness my hand and official seal the day and year above set forth.

My Commission expires December 18th, 1904

Seal
Mackregor Douglas
Notary Public

I, the undersigned, a civil engineer and surveyor, hereby certify that I re-surveyed and replatted the land described in the above certificate of The Classen Co; that such survey is correctly shown by the map and plat set out on this sheet.

Dated this 24th day of April 1902.

N. B. Spellman

Amended Plat of
Fays Addition
to Oklahoma City

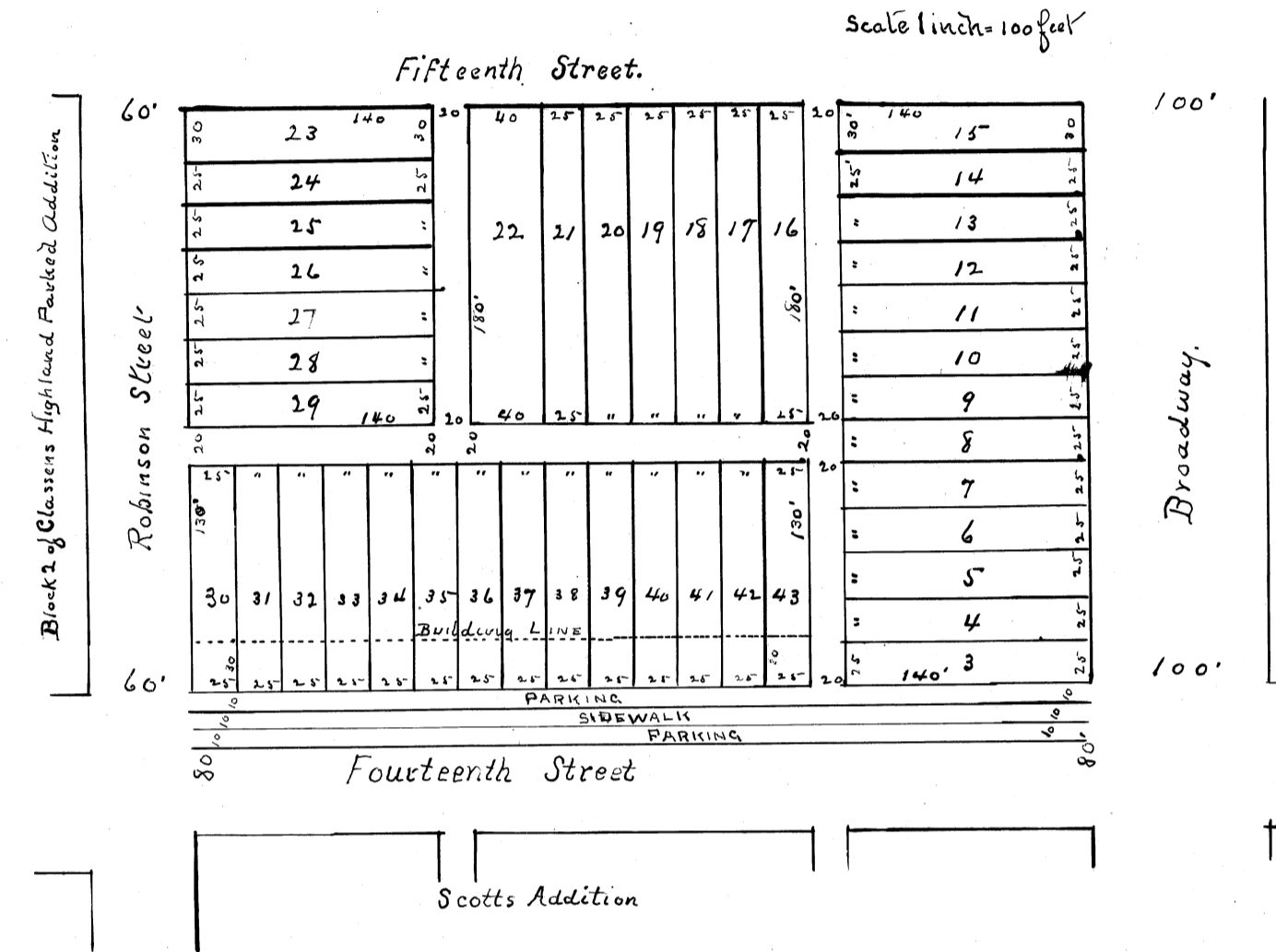

Book 3 - Page 31

3/31

DRAWING NUMBER

DRAWING NUMBER

DRAWING NUMBER 3/31

Territory of Oklahoma } S.S. This instrument was
Oklahoma County } filed for record on
the 26th day of April A. D. 1902 at 4:00 O'clock
P. M. and recorded in Book 3 Page 31.

Seal
C. J. Bowman
Register of Deeds