

Book 2 - Page 4

This instrument witnesses that the owner of the land hereinafter described to wit: Commencing at a point in the west line of right of way of the Atchison, Topeka and Santa Fe Railroad where the North line of section 33 Township No 12 North of Range No 3 West intersects the same, and running from thence South and along the said west line of right of way 35 feet to a point thence West and parallel to the north line of sec 33, 510 feet and to the East line of Broadway as laid out in Oklahoma City produced north, thence north and along said east line of Broadway produced north 35 feet, thence East and along the north line of said section 33, 510 feet and the place of beginning. That I have caused a survey of the same to be made for townsite purposes and I hereby designate the same as a Supplemental part of a part of Dale's addition to Oklahoma City and I hereby dedicate the streets, avenues and alleys pertaining thereto to the public use.

Witness my hand and seal this 2nd day of May A.D. 1900
Francis Dale

Before me a notary Public in and for said County and Territory on this 2nd day of May A.D. 1900 personally appeared Francis Dale to me known to be the identical person who executed the same, as his free and voluntary act and deed for the uses and purposes therein set forth. Witness my hand and official seal the day and year above set forth.

Thomas A Higgins Notary Public
My Commission Expires April 23 1902
(Seal)

I, Chas Chambelin a resident of Oklahoma County Oklahoma Territory do hereby certify that by occupation I am a civil Engineer and surveyor. That at the instance of - I surveyed a part of ground as shown below and described as follows: Commencing at a point in the west line of right of way of the Atchison Topeka and Santa Fe R.R. where the north line of section 33 Township No 12 North of Range No 3 West intersects the same and running from thence South and along the west line of right of way 35 feet to a point; thence West and parallel to the north line of section 33, 510 feet and to the East line of Broadway as laid out in Oklahoma City produced north; thence north and along said east line of Broadway produced north 35 feet; thence East and along north line of section 33, 510 feet and to place of beginning. That I have made a survey of said tract of land as shown below which I hereby certify is correct.

Chas Chambelin
City Engineer and Surveyor

Territory of Oklahoma Oklahoma County SS. Before me a notary Public in and for said County and Territory on this - - day of - - A.D. 1900 personally appeared Chas. Chambelin to me known to be the identical person who executed the within and foregoing instrument and acknowledged to me that he executed the same as his free and voluntary act and deed for the uses and purposes therein set forth. Witness my hand official seal the day and year above set forth.

My Com. exp. - - - - - Notary Public

May 4th
6:00 p.m.
1900
J. Bowman
C.W. Stephenson
(Seal)

Supplemental
Plat
of
Part of Florence
Addition
To
Oklahoma City
April 1900
Chas Chambelin
City Engr

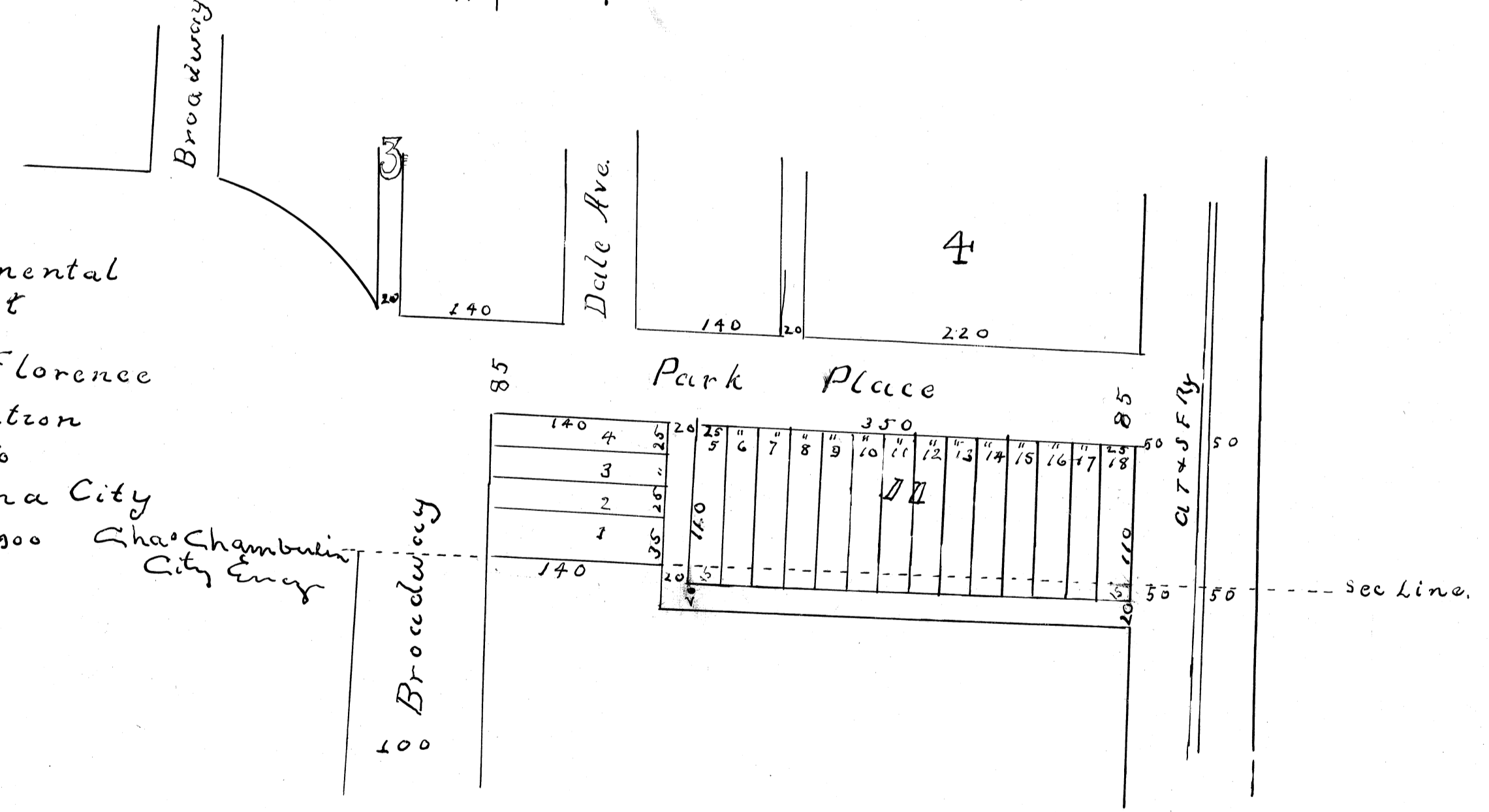

2/4