

DRAWING NUMBER  
**18/1**

2 of 2

PLAN HOLD CORPORATION • IRVINE, CALIFORNIA  
REORDER BY NUMBER 075AR  
POSITION EDGE OF PRINT ON THIS LINE

# HARE'S PARK PLACE

Subdivision of Lot No. 2 of the  
**LINCOLN VIEW ADDITION**

to  
**Oklahoma City, Okla.**

Scale: 1 in = 50 ft.

10850

12  
mch  
14  
18  
S. Coates  
#600

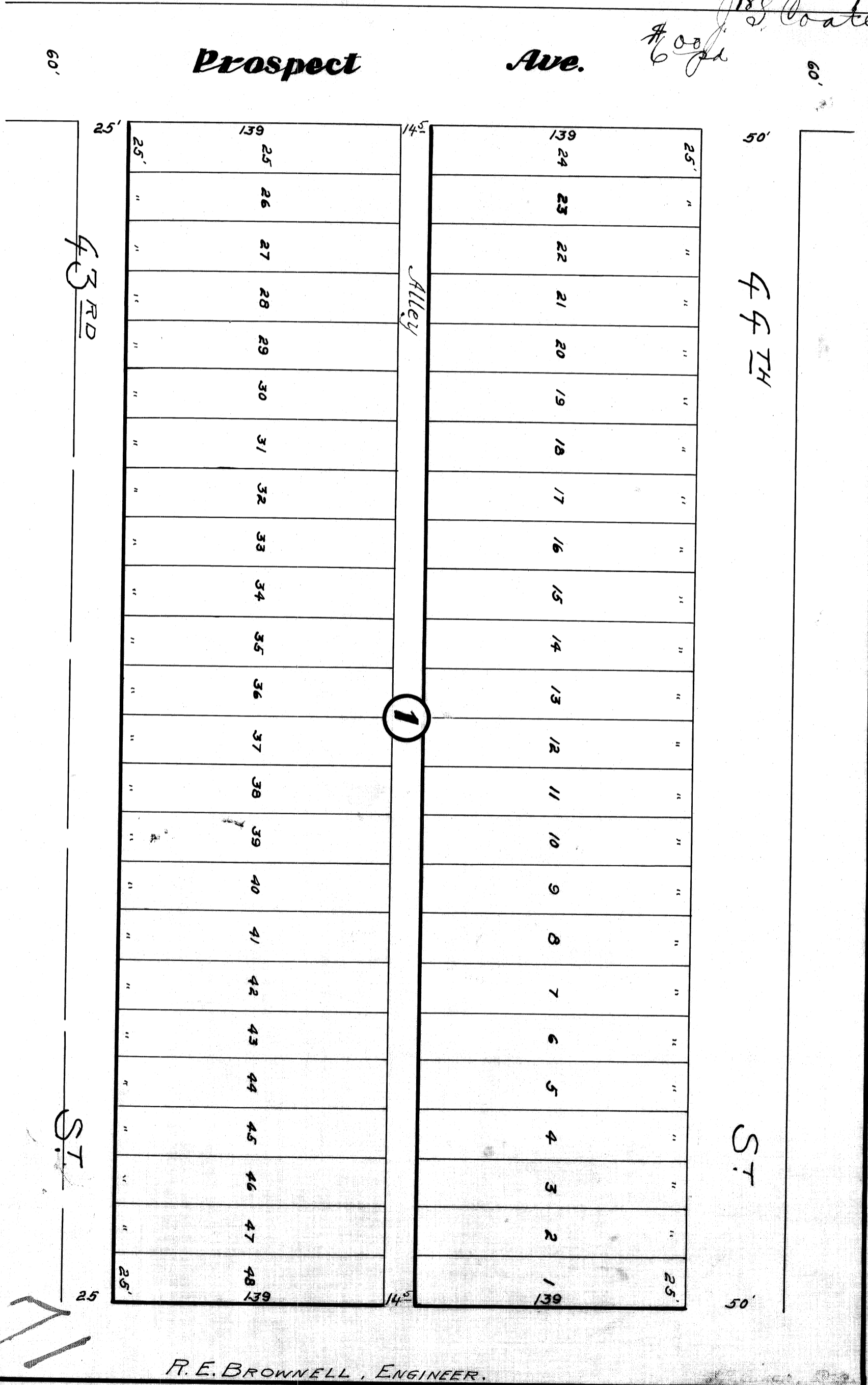

R. E. BROWNELL, ENGINEER.

DRAWING NUMBER  
**1811**

**1 of 2**

PLAN HOLD CORPORATION • IRVINE, CALIFORNIA

REORDER BY NUMBER 075AR

POSITION EDGE OF PRINT ON THIS LINE

**D E D I C A T I O N :**

THIS INSTRUMENT WITNESSETH: That we, Alfred Hare and Bertha Hare, husband and wife, are the owners of Lot Two (2) of the Lincoln View Addition to Oklahoma City, Oklahoma, in Section Fourteen (14), Township Twelve (12) North, of Range Three (3) West of the Indian Meridian, Oklahoma County, Oklahoma.

That we have caused the same to be surveyed into lots, street and alley in conformity to and as shown on the plat hereto annexed, which we hereby adopt as the plat of the above described property under the name of HARE'S PARK PLACE SUBDIVISION OF LOT Two (2) of the Lincoln View Addition to Oklahoma City, Oklahoma.

That said alley and street shown on the plat are hereby dedicated to the public use forever.

WITNESS Our hands and seals this 14th day of January, 1912.

*[Handwritten initials]*

Alfred Hare  
Bertha Hare

STATE OF OKLAHOMA,)

(SS.

COUNTY OF OKLAHOMA)

Before me, A. S. Davis, a Notary Public, in and for said County and State, on this the 16th day of January, 1912, personally appeared Alfred Hare and Bertha Hare, husband and wife, to me well known to be the identical persons who signed the within and foregoing instrument and acknowledged to me that they executed the same as their free and voluntary act and deed, for the uses and purposes therein set forth.

WITNESS My hand and official seal this the day and year above written.

A. S. Davis  
Notary Public.

My Commission Expires, Nov. 20th, 1913

STATE OF OKLAHOMA,)

(SS.

COUNTY OF OKLAHOMA)

Surveyor's Certificate:

I, R. E. BROWNELL, a resident of Oklahoma County, State of Oklahoma, do hereby certify that I am by profession a Civil Engineer and Surveyor, and that at the instance of Alfred Hare and Bertha Hare, his wife, did survey and plat into lots, street and alley, Lot Two (2) of the Lincoln View Addition to Oklahoma City, Oklahoma, in Section Fourteen (14) Township Twelve (12) North, of Range Three (3) West of the Indian Meridian, Oklahoma County, Oklahoma, the same being known as HARE'S PARK PLACE SUBDIVISION.

I further certify that the attached map or plat of same is a true and correct representation of said survey.

R. E. Brownell

STATE OF OKLAHOMA,)

(SS.

COUNTY OF OKLAHOMA)

Before me, A. S. Davis, a Notary Public, in and for said county and state, on this the 16th day of January, 1912, personally appeared R. E. BROWNELL, to me known to be the identical person who signed the within and foregoing instrument and acknowledged to me that he executed the same as his free and voluntary act and deed for the uses and purposes therein set forth.

WITNESS My hand and seal this the day and year above written.

A. S. Davis  
Notary Public.

My Commission Expires, Nov 20th, 1913.