

DRAWING NUMBER
19/43

1 of 2

PLAN HOLD CORPORATION • IRVINE, CALIFORNIA
REORDER BY NUMBER 075AR
POSITION EDGE OF PRINT ON THIS LINE

19/43
0

SUB OF LOTS
60 TO 63 INC.
HARNDALE ~

OKLA. CITY OKLA
83016
Which is a Subdivision of
the N.W. 30 Acres of the
S.W. 1/4 of SEC. 28 T.12 N.R.3 W.1.M.

WESTERN AVE.

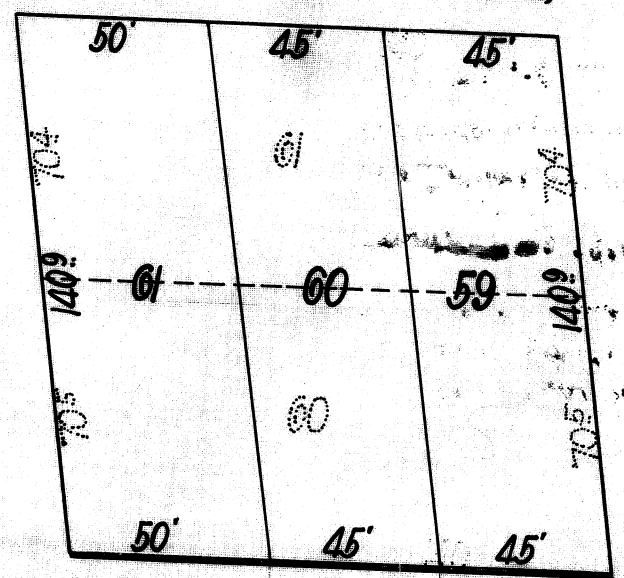
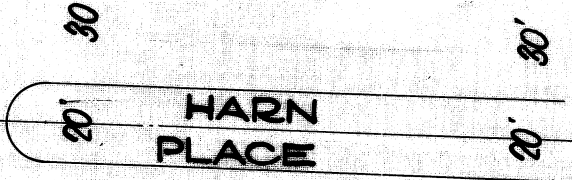
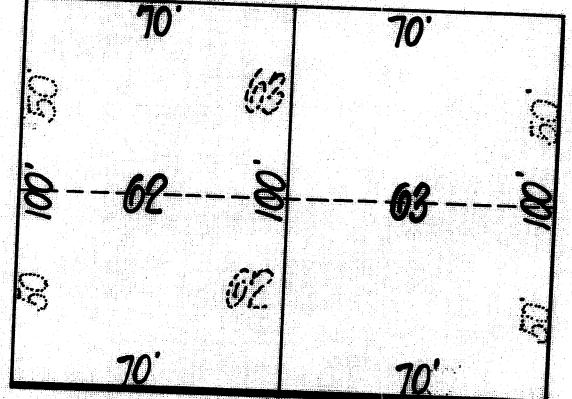

STATE OF OKLAHOMA }
Oklahoma County } SS.
This instrument was filed for
5e P 2
at 10:10 AM, and recorded
in Book _____ Page _____
M. L. ...
County Clerk

19

SUB OF LOTS 60 To 63 Inc. HARNDALE

OKLAHOMA CITY, Okla.

which is a subdivision of the N. W. 30 acres of the S. W. 1/4 of Sec. 28 T. 12 N. R. 3 W. I.M.

KNOW ALL MEN BY THESE PRESENTS:-

That the Interstate Building & Loan Co., a corporation, being the owners of lots Sixty (60) to sixty three (63) inclusive Harndale, as filed in the Register of Deeds in Oklahoma County, Oklahoma, in Plat Book No. Seventeen (17) Pages 41, 42, and 43 have caused the same to be amended and that the annexed map or plat is a correct representation of said lots as amended.

Signed this 1st day of September 1916

INTERSTATE BUILDING & LOAN CO.,

By A. C. Enochs
Its President.

Attest F. A. Dodds
Its Secretary

State of Oklahoma, County of Oklahoma, ss.

Before me, the undersigned, a Notary Public in and for said County and State on this 1st day of September 1916, personally appeared A. C. Enochs, to me known to be the identical person who executed the within and foregoing instrument and acknowledged to me that he executed the same as his free and voluntary act and deed and as the free and voluntary act and deed of said corporation for the uses and purposes therein set forth.

Witness my hand and notarial seal this 1st day of Sept. 1916:

M. E. Stinson
Notary Public

My commission expires May 29, 1920.

I, Bert M. Hart, a resident of Oklahoma County, Oklahoma, hereby certify that I am by profession a Civil Engineer, and that at the instance of the Interstate Building and Loan Co., I made the amended survey of the above described lots and that the annexed map or plat is a correct representation of the amended survey as made by me.

Signed this 31 day of August 1916:

Bert M. Hart
Civil Engineer.

State of Oklahoma, County of Oklahoma, ss.

Before me the undersigned, a Notary Public, in and for said County and State on this 1st day of Sept. 1916, personally appeared Bert M. Hart, to me known to be the identical person who executed the within and foregoing instrument and acknowledged to me that he executed the same as his free and voluntary act and deed for the uses and purposes therein set forth.

Witness my hand and notarial seal this 1st day of Sept. 1916.

Mary Hutchinson
Notary Public

My commission expires March 12th, 1919:

19/43

43