

HARRAH'S Addition.

Showing Subdivisions of Block 202 & 203 of Hudson Ave to 9th Street

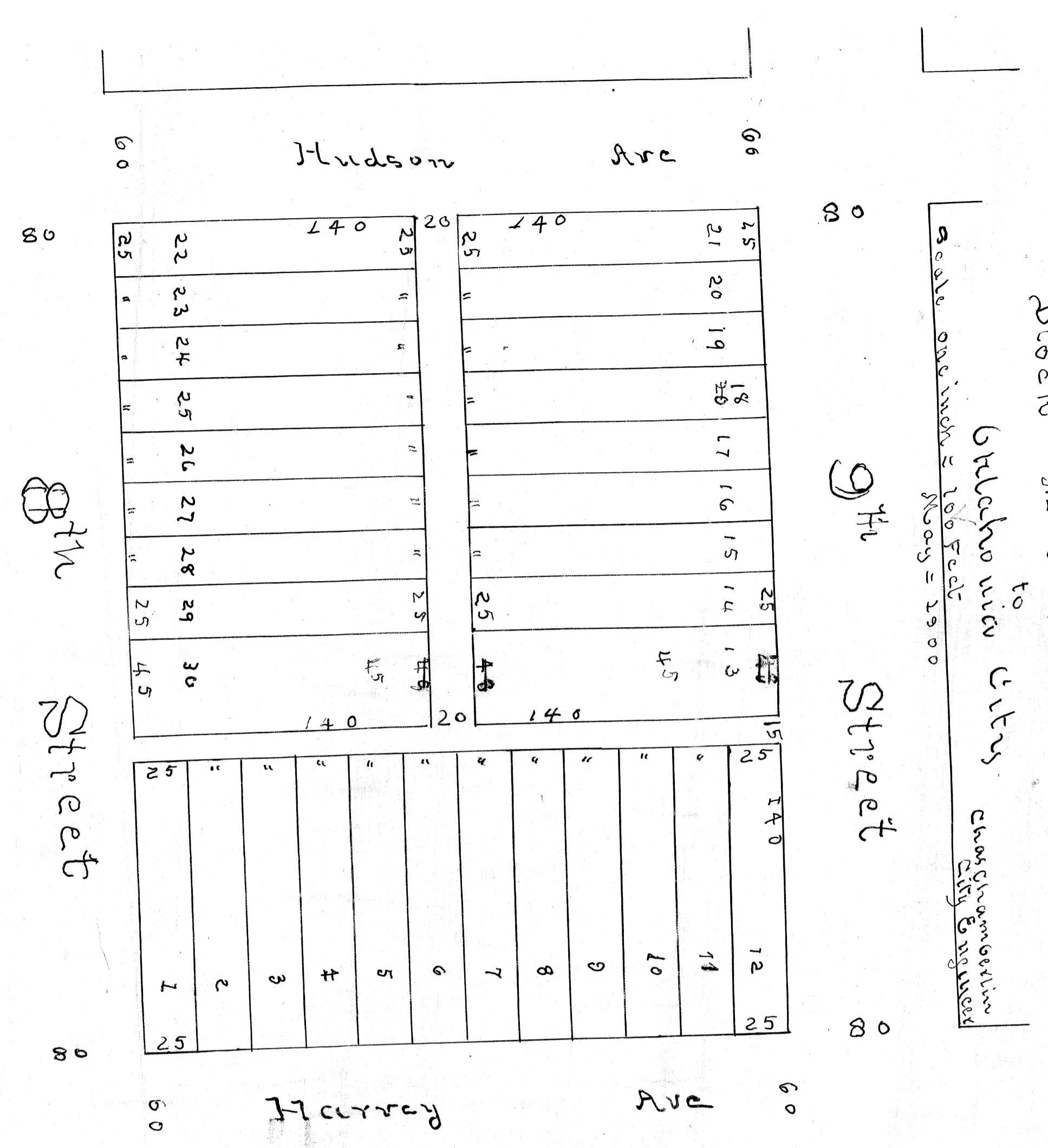

This instrument witnesses that J.A. Jossie, J.S. Childers, Sallie L. Bowen, G.H. Bales, W.H. Sanford, Jessie Harrah, W.P. Hawkins, W.H. Edwards, Fannie L. Erlwin, Maud L. Wardrop, J.S. Erlwin, F.E. Jones, Jennie L. Fairbank, of Oklahoma County Oklahoma Territory the owners of the land hereafter described have caused the same to be surveyed into lots for townsite purposes and we hereby designate the same as Harrah Addition to Oklahoma City. That we have caused to be made a correct plat of said land in survey that the land surveyed and plotted by me said is described and bounded as follows to wit: Commencing at a point in the east line of Hudson Ave as laid out in Oklahoma City produced northward and distant from the north line of Seventh Street 380 feet and from said point running northward and along the north east line of Hudson Ave produced 300 feet. Thence easterly and along a line parallel to said 7th Street 400 feet and to place of beginning and westerly and parallel to Hudson Avenue produced 300 feet. Thence southerly and parallel to Hudson Avenue produced 300 feet. Thence westerly and parallel to 7th Street 400 feet and to place of beginning. Witness our hands and seals this 27 day of May A.D. 1900.

J.A. Jossie, J.S. Childers, Sallie L. Bowen, G.H. Bales, W.H. Sanford, Jessie Harrah, W.P. Hawkins, W.H. Edwards, Fannie L. Erlwin, Maud L. Wardrop, J.S. Erlwin, Nettie L. Hall, Effie E. Jones, Jennie L. Fairbank

Notary of Oklahoma County of Oklahoma, ss. Before me R.D. Hall a notary public in and for said County and Territory on this 27 day of May A.D. 1900 personally appeared J.A. Jossie, J.S. Childers, Sallie L. Bowen, G.H. Bales, W.H. Sanford, Jessie Harrah, W.P. Hawkins, W.H. Edwards, Fannie L. Erlwin, Maud L. Wardrop, Nettie L. Hall, Effie E. Jones, Jennie L. Fairbank to me known to be the identical persons who executed the same as their free and voluntary act and acknowledged to me that they execute the same as their free and voluntary act and for the uses and purposes therein set forth. Witness my hand and official seal the day and year above set forth.

R.D. Hall Notary Public (Seal)

My Commission Expires April 23 1903

This instrument witnesses that I Charles Chamberlin a resident of Oklahoma County Oklahoma Territory do hereby certify that by occupation I am a civil engineer and surveyor. That at the instance of J.A. Jossie, J.S. Childers, Sallie L. Bowen, G.H. Bales, W.H. Sanford, Jessie Harrah, W.P. Hawkins, W.H. Edwards, Fannie L. Erlwin, Maud L. Wardrop, J.S. Erlwin, Nettie L. Hall, Effie E. Jones, Jennie L. Fairbank of Oklahoma County Oklahoma Territory I surveyed into lots the following described land: Commencing at a point in the east line of Hudson Ave as laid out in Oklahoma City produced northward and distant from the north line of Hudson Avenue produced northward 300 feet. Thence easterly and along the line parallel to said 7th Street 400 feet. Thence southerly and parallel to Hudson Avenue produced 300 feet. Thence westerly and parallel to 7th Street 400 feet and to place of beginning. And that the plat or map accompanying this is a true and correct copy of the said survey as surveyed by me.

Charles Chamberlin City Engineer.

Notary of Oklahoma County of Oklahoma, ss. Before me R.D. Hall a notary public in and for said County and Territory on this 20th day of June A.D. 1900 personally appeared Charles Chamberlin to me known to be the identical person who executed the same as his free and voluntary act and acknowledged to me that he executed the same as his free and voluntary act and for the uses and purposes therein set forth. Witness my hand and official seal the day and year above set forth.

R.D. Hall Notary Public

Filed for record this 20 day of June, 1900 at 4 P.M.

J. Bowman Registered

My Commission Expires April 23 1903 (Seal)

DRAWING NUMBER
0/0

DRAWING NUMBER

DRAWING NUMBER

2/0

PLAT HOLD CORPORATION - IRVINE, CALIFORNIA
REGISTERED BY NUMBER 173481
PRINTED IN U.S.A.